



# Return to Hockey Townhall Meeting

February 28, 2021

# Agenda



- Review Return to Rink Protocols
  - Process and Procedures
- Questions & Answers

# Review Return to Rink Protocols



## Before Arriving at EGSC

- SportsHeadz health screening form must be filled out by each player and coaches 2 hours before coming to the rink.
- If a player has not submitted the pre-check health screening, then as a coach it is your responsibility to ensure they are not allowed in the rink.

## Arriving at EGSC

- No late arrivals will be permitted, as doors will be locked once cohort has moved into the arena.

# Review Return to Rink Protocols



## Arriving at EGSC

- Only **12** people per ice pad will be allowed in the EGSC.
- EGSC doors will always be locked during hours of operations.
- All players should come fully dressed carrying their helmet, stick, skates, and a filled water bottle. Small bags are allowed in the rink at this time. All water bottles must be labelled with the player's name.
- Players will not be allowed in the EGSC until 10 minutes before their ice slot, line up on the designated spots at the main sliding door entrance.
- Once your complete group has arrived, Coaches are to call the posted number (905)806-2949 and a Municipal Staff will open the door to let you in. Do not call until all members of your group are present.
- All players entering the EGSC will be required to wear a face mask. Hand sanitizing station will be throughout the facility.

# Review Return to Rink Protocols



## While in EGSC

- Upon entry to the EGSC, players will be directed to a designated ice pad and seating area to put on helmet and skates.
- Once dressed, the player will move to the ice for their 50-minute time slot.
- For younger age groups, bench staff will be responsible for helping with tying skates, skate's guards and helmets. Bench staff assisting players must wear a face mask. Players may also enter the rink with skates tied wearing skate guards.
- No spectators or parents/guardians will be allowed in the facility for U8 to U18 age groups, only participants and coaches/skill trainers. U7 and under one guardian will be allowed to enter the building to tie skates and then move to the designated viewer area for the practice.
- **All Changerooms will remain closed at this time. NO GOALIE ROOMS**

# Review Return to Rink Protocols



## While in EGSC

- If a coach is not on the ice and uses the bench mask and gloves must be worn.
- Access to a washroom will be provided. Use of the NewRoads washroom will be made available. Social distancing must be maintained to and from the washroom.
- Water fountains/filling stations are not available.

## Exiting EGSC

- There will be a designated exit for each ice pad. If you are on the NewRoads rink you will exit at the West Doors, and if you are using the Atlas Rink you will exit from the East doors. These doors should only be used to exit the facility. Please use the appropriate markers to assist in your safe exit.
- After each game/practice, the player will be directed quickly back to their seat, to remove their skates and helmet. When the helmet has been removed, they will be required to put their face mask on.

# Review Return to Rink Protocols



## Exiting EGSC

- To ensure we move players out quickly we recommend coaches take last 5 minutes of ice time to gather training equipment, pucks/pylons...
- Players will have 5 minutes to exit the building once Ice Time is over, any delay will cause new group of skaters not being allowed in as we must adhere to the 50-person limit. Coaches should be the last to leave the arena ensuring all players/coaches have left the building.
- Once participants have cleared the arena, municipal staff will use the remaining time between rentals to clean and disinfect high touch points and the areas that have been accessed. Once cleaning is completed, the next group will be allowed to enter

# Review Return to Rink Protocols



## East Gwillimbury Sports Complex:

Flow Diagram for EGMHA

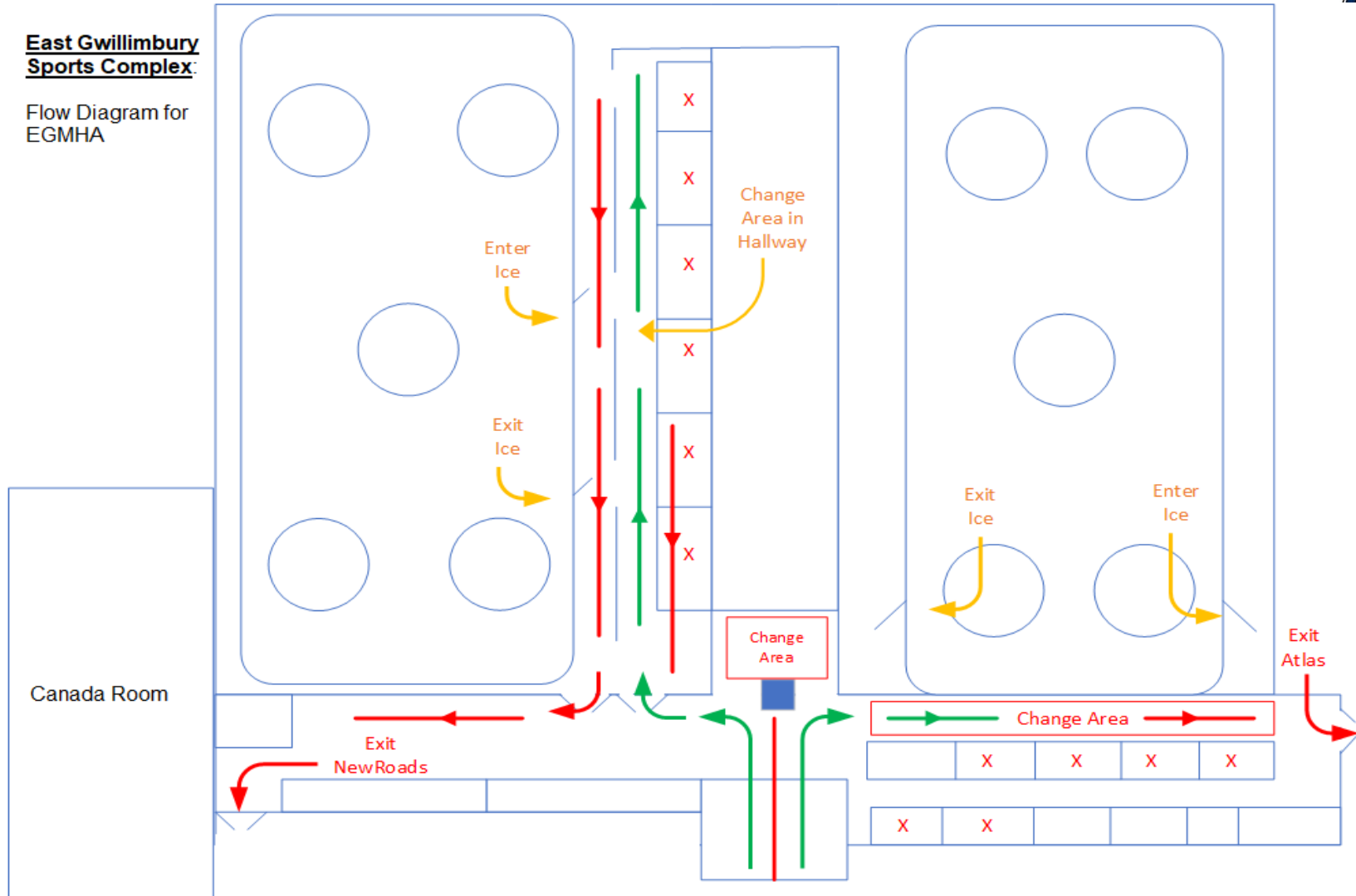





# Question & Answers